

UV System Dulcodes S with Powerline lamp

Effective chloramine reduction in pool water

Dulcodes S UV systems are ideal for breaking down bound chlorine (chloramines) in swimming pool water. These odor-intensive substances (“chlorine odor”) irritate the eyes and mucous membranes. Special Powerline medium pressure lamps generate intensive UV radiation for the effective reduction of the chloramines.

In addition, chlorine-resistant germs in the water are reliably killed, resulting in better and healthier water quality. The in-line design ensures that the system is simple and easy to install in any position: quick retrofitting with minimal work, directly into a plastic pipeline without any stainless steel connection pieces required.

Application Specific Solutions

- Swimming pools
- Water parks
- Spray pads
- Zoos and Aquariums

Features & Benefits

- Minimum space requirement due to extremely compact in-line design
- Highest level of installation flexibility due to free choice of mounting orientation
- Maintenance-friendly single-end lamp connection
- Quick payback due to operating cost savings in fresh water, chemicals and heating
- Additional disinfection barrier for chlorine-resistant germs
- High operating safety and simple diagnostics thanks to integrated screen recorder
- Manual or automatic wiper
- Radiation chamber from high quality stainless steel 316 Ti
- Power output control in steps 50, 75 and 100 %
- Monitoring of the system performance by UVC-selective sensor
- Monitoring of the water temperature
- Resource saving operation made possible through control which depends on the concentration of bound chlorine



UV System Dulcodes S with Powerline lamp

Dimensional drawings

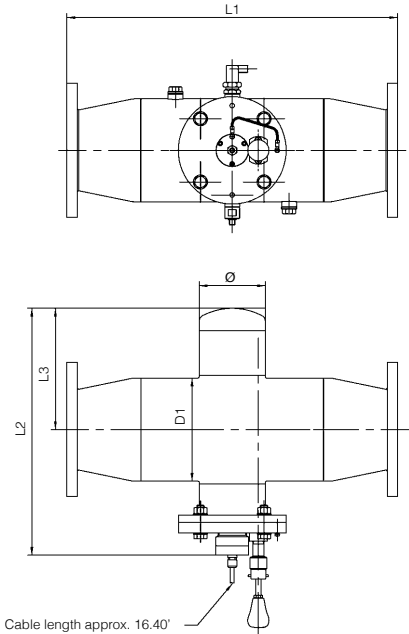

Radiation chamber

	0.65 kW	1 kW	2 kW	3 kW	4-9 kW
D1	4.49"	6.62"	8.62"	12.75"	12.75"
L1	19.68"	27.55"	27.55"	31.49"	35.43"
L2	15.15"	16.73"	20.66"	24.60"	25.03"
L3	5.59"	8.18"	10.15"	12.12"	12.54"
Ø	3.50"	5.50"	5.50"	5.50"	10.74"

Control cabinet (Not Shown)

H	14.96"	19.68"	23.62"	23.62"	55.11"
W	14.96"	19.68"	23.62"	23.62"	23.62"
D	8.26"	8.26"	8.26"	8.26"	11.81"

Specifications

Type	Max flow [m ³ /h] with 98%/cm transmission and UV-dose		Number of lamps and lamp power [kW]	Connector nom. dia. Din 2576 selectable
	400 J/m ²	600 J/m ²		
1 x 0.65S*	26	17	1 x 0.65	DN 65 DN 80
1 x 1S**	77	51	1 x 1	DN 100 DN 125
1 x 2S	134	89	1 x 2	DN 125 DN 150
1 x 3S	266	177	1 x 3	DN 200 DN 250
2 x 2S	360	240	2 x 2	DN 200 DN 250
2 x 3S	495	330	2 x 3	DN 250
3 x 3S	750	500	3 x 3	DN 250 DN 300

* System without wiper and no power control

** System without power control

Maximum operating pressure 87.02 psi